



Manhattan Building, 60 Fairfield Road, Bow

Quarter

Asking Price £340,000 Leasehold

OLIVER *OJ* JAKQUES
EST.1986



Manhattan Building, 60 Fairfield Road, Bow Quarter

A beautifully presented third floor, one bedroom mezzanine apartment located within the Bow Quarter. Set over two levels, the property comprises a bespoke open-plan kitchen with high gloss units, a reception area with high ceilings, wood flooring and a large factory window with internal ground views and stairs to the large mezzanine double bedroom with great wardrobe space. The gated development offers a 24 hour concierge, on-site convenience store, gymnasium, sauna, steam room and swimming pool.

- 24 Hour Concierge
- Swimming Pool & Gym
- Factory Windows
- High Ceilings
- Gated Development
- Communal Grounds

Oliver Jaques Bow Lettings
020 8980 0999

Email east@o-j.co.uk

Unit A Arlington Building, 60 Fairfield Road, London, E3 2UB

web www.o-j.co.uk

Every care has been taken with the preparation of this brochure but it is for general guidance only and complete accuracy cannot be guaranteed. If there is any point, which is of importance professional verification should be sought. This brochure does not constitute a contract or part of a contract. We are not qualified to verify tenure of property. Prospective purchasers should seek clarification from their solicitor or verify the tenure of this property for themselves by visiting www.gov.uk/government/organisations/land-registry. The mention of any appliances, fixtures or fittings does not imply they are in full working order. Photographs are reproduced for general information and it cannot be inferred that any item shown is included in the sale. All dimensions are approximate. Walking times are taken from Google Maps and measured from the centre of the postcode, which may differ from the individual property. We routinely refer clients to Chancery Mortgage Services Ltd. It is your decision whether you choose to deal with Chancery Mortgage Services Ltd. In making that decision, you should know that we receive an annual payment benefits from Chancery Mortgage

Fairfield Road, Bow Quarter, London, E3

Total = 413 sq ft / 38.4 sq m (excludes void)

For identification only - Not to scale

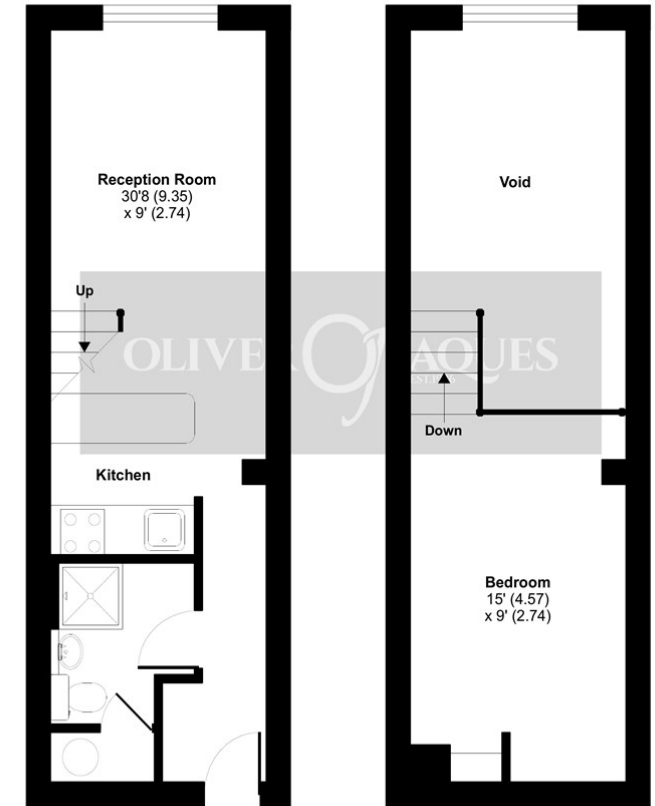

THIRD FLOOR

FOURTH FLOOR



Floor plan produced in accordance with RICS Property Measurement Standards incorporating International Property Measurement Standards (IPMS2 Residential). © richcom 2022. Produced for Oliver Jaques. REF: 802744

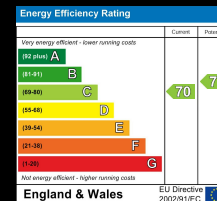

Tenure: Leasehold

Ground Rent: TBC

Service Charge: TBC

Lease Expires: TBC

Shared Ownership: No

Council Tax Band: Tower Hamlets London Borough Council (Band C)

£TBC